



SEEMRAY
YOUR HOME YOUR WAY



CATALOG

ENTRY DOORS





Inox Series Entry Doors

Set the stage for your modern home with an entrance to match. The exquisite Inox exterior doors by Nova Doors balance strength and transparency with reflective glass and stainless steel accents. Each design includes your choice for a high-grade finishing color, sidelight or transom installation, and additional trim. The 3.5-inch door is guaranteed to fit all standard American openings and is equipped with security that you can count on as well as 25 year industry leading warranty.

Features:

- Reinforced Stainless Steel Door Edge
- Long Stainless Steel Bar Handle
- 3 Prong High Level Security Lock
- Line Welded Steel Door Frame
- Heavy Duty Welded Ball Bearing Hinges
- Reinforced Structural Steel Frame
- Thermoisolated Core
- Zinc Primer
- 3mm Solid Stainless Steel Protective Sheet
- Powder Coated Finished Steel Surface

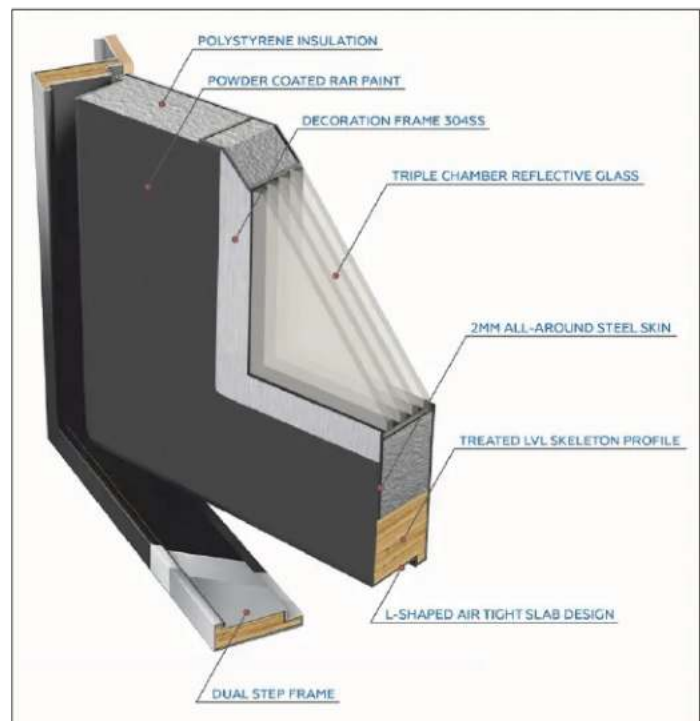

INOX SERIES ENTRY DOORS



INOX S1 BLACK



INOX S1 BROWN



INOX S1 GRAY



INOX S1 WHITE



INOX S2 BLACK



INOX S2 BROWN



INOX S2 GRAY



INOX S2 WHITE



INOX S3 BLACK



INOX S3 BROWN



INOX S3 GRAY



INOX S3 WHITE



INOX S4 BLACK



INOX S4 BROWN



INOX S4 GRAY



INOX S4 WHITE



INOX S5 BLACK



INOX S5 BROWN



INOX S5 GRAY



INOX S5 WHITE



INOX SERIES ENTRY DOORS



Available Configuration



SINGLE DOOR



LEFT SIDELIGHT



RIGHT SIDELIGHT



DOUBLE SIDELIGHTS



TRANSOM



LEFT SIDELIGHT & TRANSOM



RIGHT SIDELIGHT & TRANSOM



BOTH SIDELIGHTS AND TRANSOM



DOUBLE



DOUBLE W/ LEFT SIDELIGHT



DOUBLE W/ RIGHT SIDELIGHT



DOUBLE W/ BOTH SIDELIGHTS



DOUBLE W/ TRANSOME



DOUBLE W/ LEFT SIDELIGHT
AND TRANSOME



DOUBLE W/ RIGHT SIDELIGHT
AND TRANSOME



DOUBLE W/ BOTH SIDELIGHTS
AND TRANSOME



Royal Series Wrought Iron Entry Doors

- Made of heavy 12 gauge steel.
- Hinged glass option allowing easy access for cleaning and ventilating.
- Mosquito screen option.
- Window lock controls the opening and closing of glass frame.
- Polyurethane foam layer adds insulation from the heat or the cold.
- All thresholds are hand- forged and fully-welded.
- All of our doors undergo a unique seven-step process: Sandblast, Zinc-coat, anti-corrosive prime, middle coat, top coat, faux finish, clear coat.
- Rubber weatherstripping is installed around the door frame and around the interior glass frame.
- Door sweep is installed underneath the door.
- Up and down extension ball latches are installed on all doors.
- On the lower half of the window, there is a small decline for water to run-off.
- All doors come with a standard deadbolt lock.
- Any size or custom design available.

Glass Option

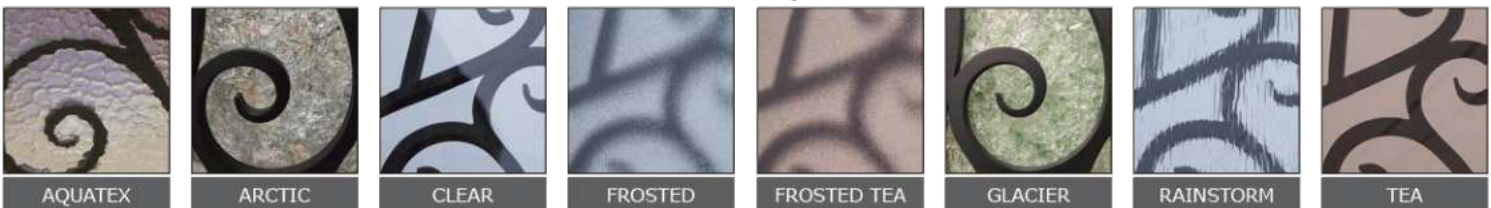

Door Finish Option



ROYAL SERIES WROUGHT IRON ENTRY DOORS



ROYAL 001



ROYAL 002



ROYAL 003



ROYAL 004



ROYAL 005



ROYAL 006



ROYAL 007



ROYAL 008



ROYAL 009



ROYAL 010



ROYAL 011



ROYAL 012



ROYAL 013



ROYAL 014



ROYAL 015



ROYAL 016



ROYAL 017



ROYAL 018



ROYAL 019



ROYAL 020



ROYAL 021



ROYAL 022



ROYAL 023



ROYAL 024



ROYAL 026



ROYAL 027



ROYAL 028



ROYAL 029



ROYAL 030



ROYAL 031



ROYAL 032



ROYAL 033

ROYAL SERIES WROUGHT IRON ENTRY DOORS



ROYAL 034



ROYAL 035



ROYAL 036



ROYAL 037



ROYAL 038



ROYAL 039



ROYAL 040



ROYAL 041



ROYAL 042



ROYAL 043



ROYAL 044



ROYAL 045



ROYAL 046



ROYAL 047



ROYAL 048



ROYAL 049



ROYAL 050



ROYAL 051



ROYAL 052



ROYAL SERIES WROUGHT IRON ENTRY DOORS



ROYAL 053



ROYAL 054



ROYAL 055

SLIDING & BI-FOLD CLOSET DOORS

AVAILABLE GLASS FINISHES

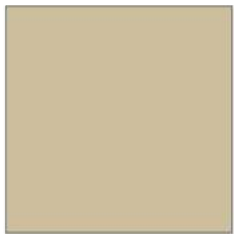

BEIGE



BLACK



BROWN



BURGUNDY



PINK



GREEN

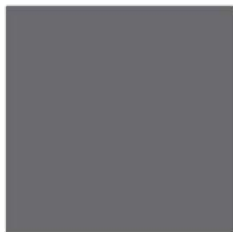

SILVER GREY



WHITE



LIGHT RED

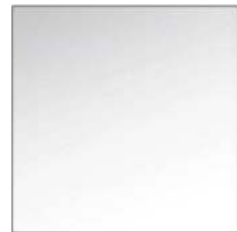

MIRROR

AVAILABLE PANEL FINISHES



LIGHT ALOE WOOD



LIGHT GREY



PRESTIGE BROWN



SWISS ELM



JAPAN OAK



KOREAN MAHOGANY

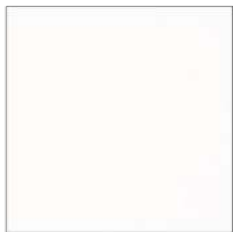

PURE WHITE



SAPELE



DARK ALOE WOOD



BLACK WALNUT



PREMIUM WENGE



WHITE DRAWING



BLACK ASH



WHITE WENGE

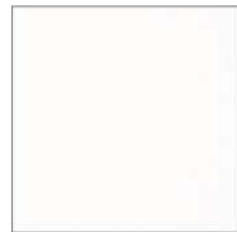

SOFT WHITE

US Standard Hardware



MODERNUS



CURVE



SIMPLICITY



VENUS



SATURN



GRANATA



JUPITER



QUAD

European Hardware



AQUILA



ARIES



DIAMOND



QUATRA



AURORA



LYRA



VEGA



VELA



QUAD BLACK



QUAD WHITE



ORION

Door Finish

- Primed - Coating that needs to be painted on site.
- Enamel Paint - 2 part paint process, thicker and more durable than traditional paint.
- PVC - Durable Laminated Coating.
- PPL - Scratch resistant, thicker finish available in textured options.
- Unfinished - Complete unfinished surface, needs to be primed, painted or stained.
- Wood Species - Natural wood to be stained (recommended).
- Wood Veneer - Available in unfinished and pre finished configuration.
- Fiber Glass - Man made material used for exterior doors.
- Steel - Steel doors made for exterior use.

Slab Only Configuration

No Hinge or Handle / No Deadbolt Prep / No Frame / No Casings

- For use in existing frames or for sliding, bypass, pocket, barn or magic option.
- Keep in mind if installing into existing frames every manufacturer has different actual slab sizes. Some are prefit anywhere from 1/8 - 3/4 inches.
- Most Interior Doors Come In 3 Thicknesses 1-3/8", 1-1/2" and 1-3/4"

Knock Down Configuration

- Includes Door Slab, Frame and Casing Set
- Hardware is Optional (We recommend Butterfly Non-Mortise Hinges)
- No Hinge Prep, No Bore Prep
- For DIY Installation



Pre-Hung Configuration

- Prepped and Assembled
- Most Popular Choice For Both Home Owners And Installers
- Faster and Easier Installation Process
- Door Slab is Pre-Cut For Hardware
- Door Is Installed on Frame Using Chosen Hardware
- Casings Cut On Site By Installer To Ensure Proper Fit

US Standard Pre-Hung

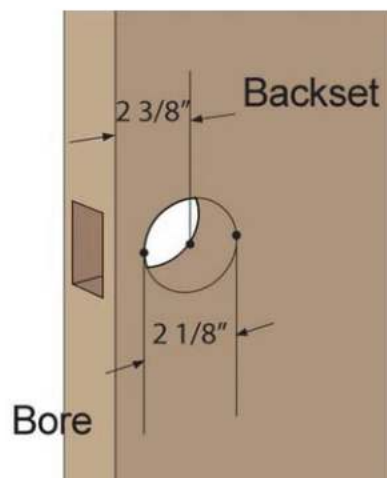

American Hole Bore:

- 2-3/8" Bore Backset is Standard.
- 2-3/4" Bore Backset Upon Request.

- Hung on Ball Bearing Mortise Hinges 3.5" x 3.5" x 5/8" Radius
- 3 Hinges for Doors up to 84 inches
- 4 Hinges for Doors over 84 inches
- Finish: Black, Brushed Satin Nickel, Polished Chrome, Polished Gold, Satin Gold



European Standard Pre-Hung

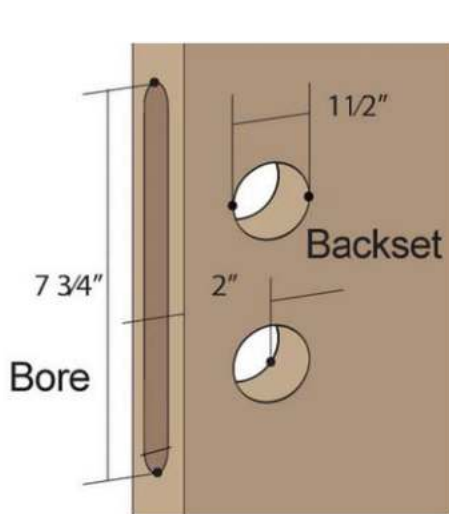

- Hung on European Invisible Hinges.
- Sleek Modern Look as Hinges are not Visible.
- Hinges are Adjustable and Easy to Rectify any Issues After Installation.
- 2 Hinges for Doors up to 84 inches
- 3 Hinges for Doors over 84 inches
- European Magnetick Lock prepped and installed.
- Passage, Privacy or Keyed Function with Round or Square Trim Option.
- Smooth Operation.
- Slimmed European Trim



Invisible 3D Hinges and US Lock Bore Pre-Hung

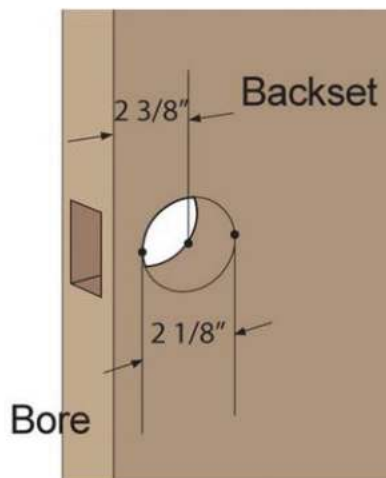

- Hung on European Invisible Hinges.
- Sleek Modern Look as Hinges are not Visible.
- Hinges are Adjustable and Easy to Rectify any Issues After Installation.
- 2 Hinges for Doors up to 84 inches.
- 3 Hinges for Doors over 84 inches.

American Hole Bore:

- 2-3/8" Bore Backset is Standard.
- 2-3/4" Bore Backset Upon Request.



European Lock Bore with Standard Hinges Pre-Hung

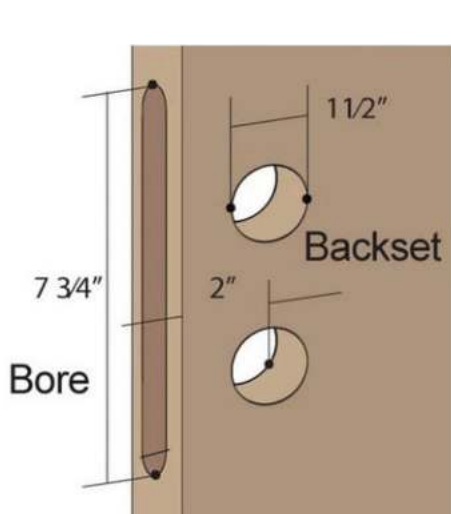

- Hung on Ball Bearing Mortise Hinges 3.5" x 3.5" x 5/8" Radius
- 3 Hinges for Doors up to 84 inches
- 4 Hinges for Doors over 84 inches
- Finish: Satin Nickel, Black, Gold, Chrome
- European Magnetick Lock prepped and installed.
- Passage, Privacy or Keyed Function with Round or Square Trim Option.
- Smooth Operation.
- Slimmed European Trim



Necessary Tools

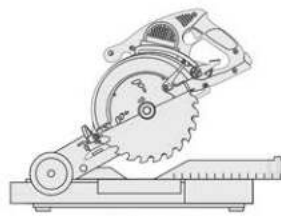

Chop Saw



Screwdriver

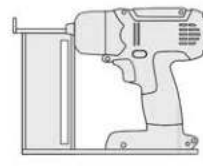

Electrofret

Finishing Nail
ONLYTape
MeasurementWater
Sprayer

Work Gloves

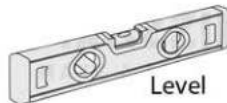

Level



Safety Glasses



Liquid Nails

Doors and Windows
Construction Foam

Square



Shims

Rubber
Hammer

Knife

Masking
Tape

Door Parts



JAMB

x2,5



CASING

x5

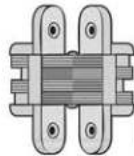

HINGES

x2

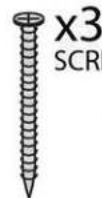
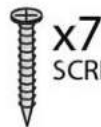
x3
SCREW 2 1/2"x7
SCREW 1 5/8"x6
SCREW 1 1/4"

DOOR SLAB

x1

EXTENSION



x2,5

WARNING!

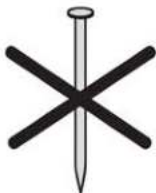
DO NOT USE STANDARD
NAILS AND HAMMER

DO NOT STEP ON THE DOOR

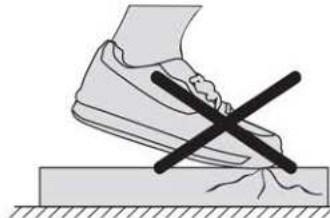
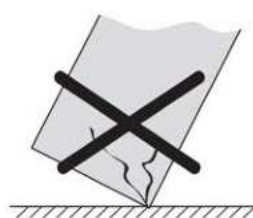
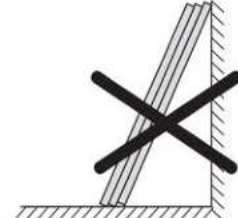
DO NOT LAY
DOWN ON EDGESDO NOT LEAN
ON THE WALL

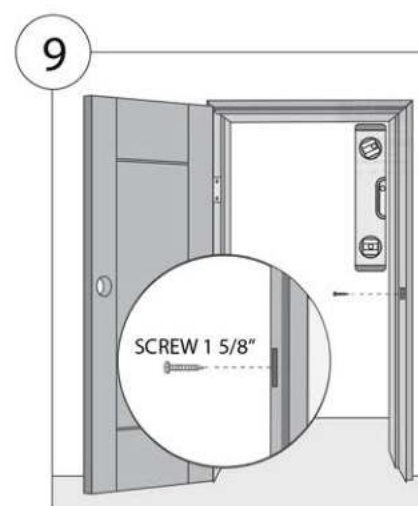
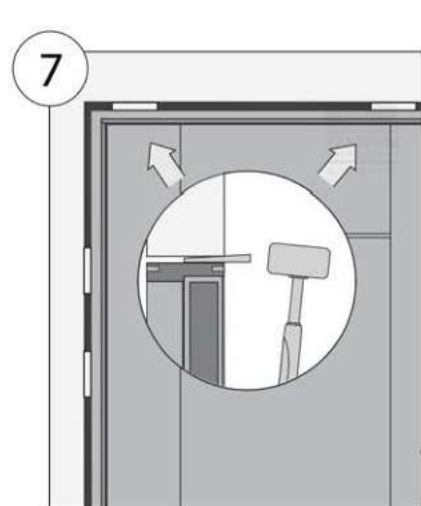
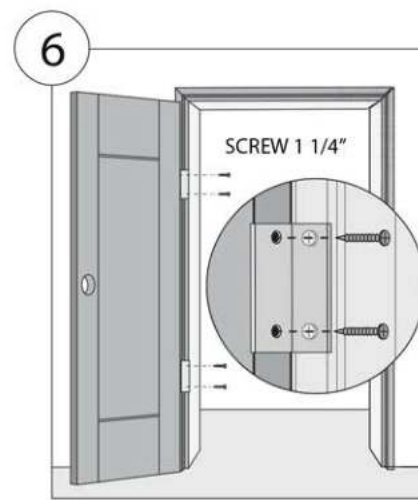
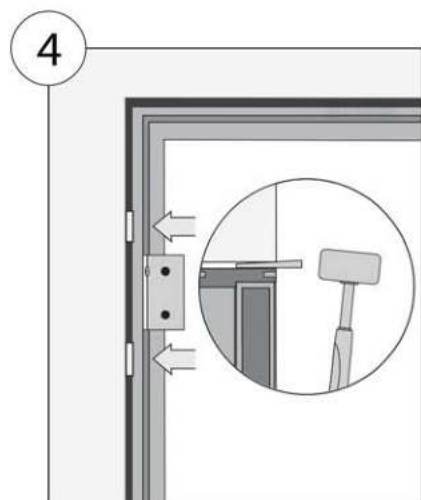
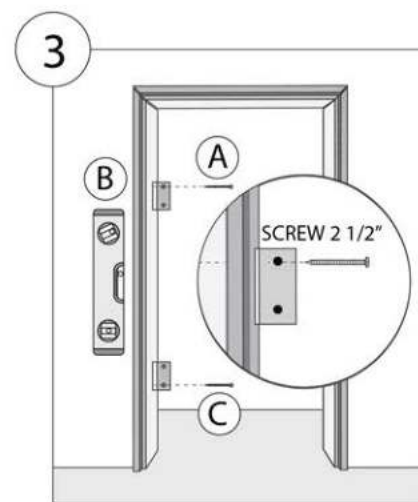
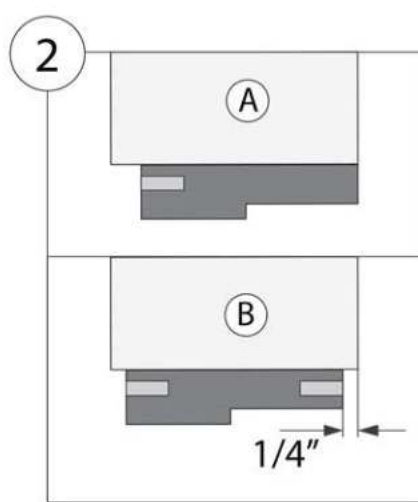
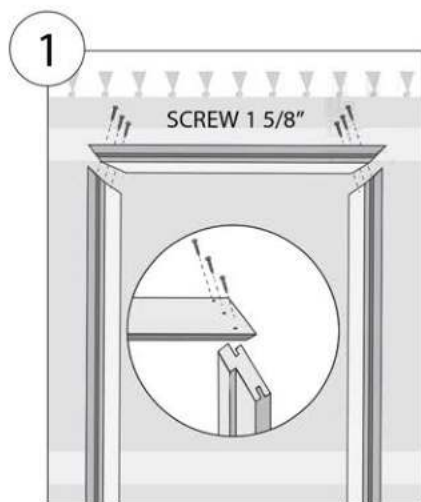

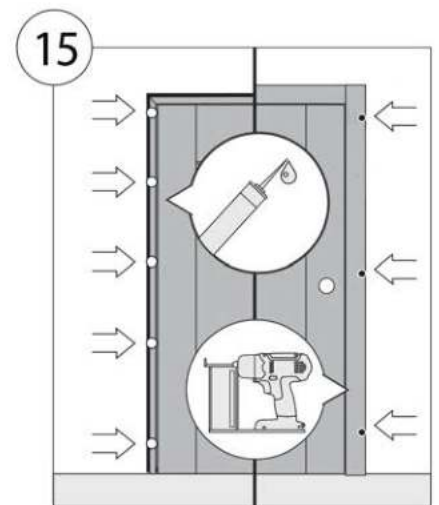
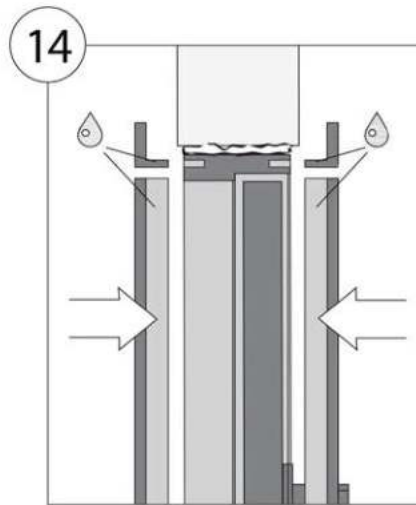
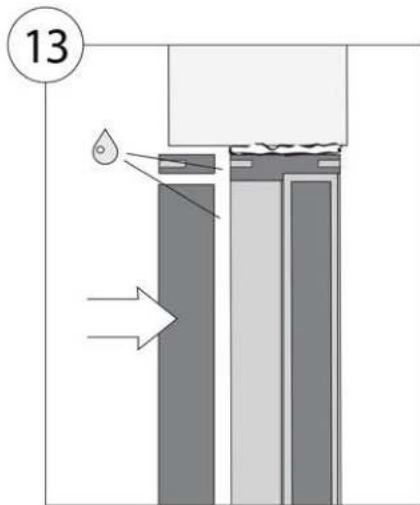
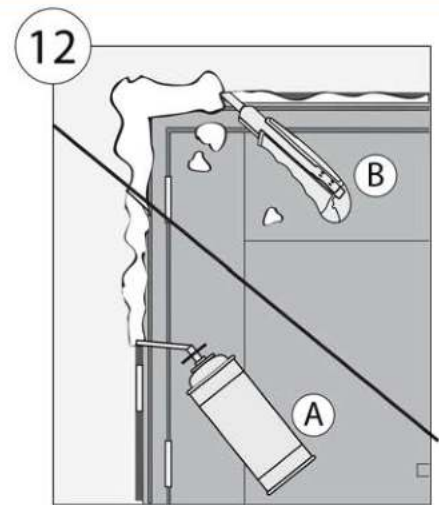
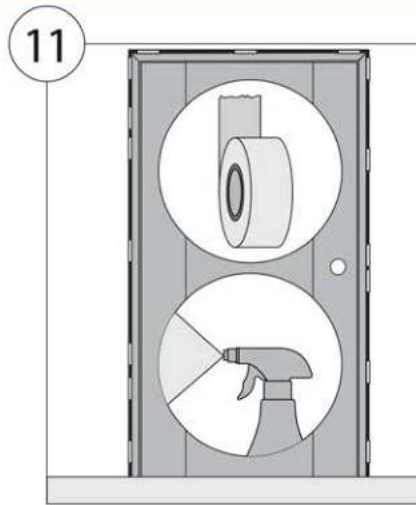
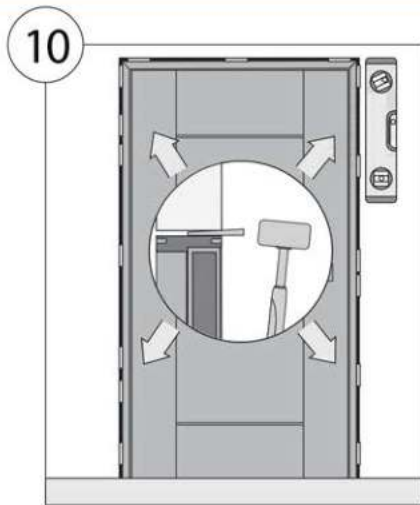

Congratulations
Installation Complete!

NOTES

STANDARD INTERIOR DOOR SIZES

18" 24" 28" 30" 32" 36"

STANDARD OPENINGS

20" 26" 30" 32" 34" 38"

SWING DIRECTIONS

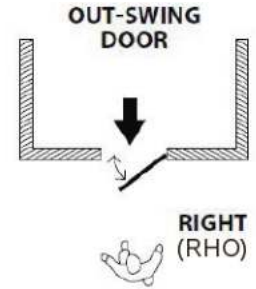
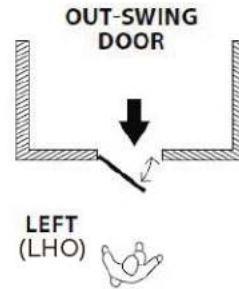
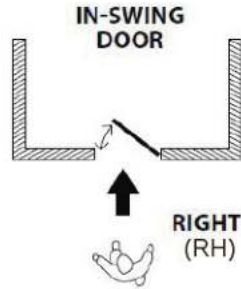
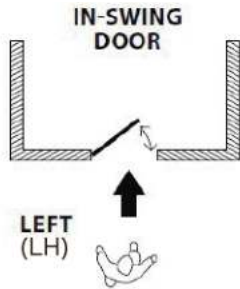

INTERIOR DOOR POSSIBLE CONFIGURATION



SINGLE



DOUBLE



POCKET



DOUBLE POCKET



BI-FOLD



BYPASS



MAGIC



BARN



SEEMRAY
YOUR HOME YOUR WAY

4500 LEE RD #F CLEVELAND, OH 44128, USA

info@seemray.com

www.seemray.com

HAVE A QUESTION?
SEEMRAY IS HERE TO HELP

+1-888-315-9973